

EZ-Charge V2

Multi-Channel Remote



FCC Compliance

This device complies with Part 15 of the FCC Rules. Operation is subject to the following two conditions

- [1] This device may not cause harmful interface, and
- [2] This device must accept any interference received, including interference that may cause undesired operation.

Package Contents

- 1 x 15 channel remote
- 1 x magnetic holder including wall fixing screws
- 1 x 3V CR2450 battery

Installation

Wall Mount Holder

Remove cover from base by prying with flat head screwdriver

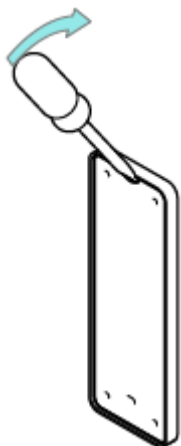

Used supplied fasteners and anchors to attach the base to the wall

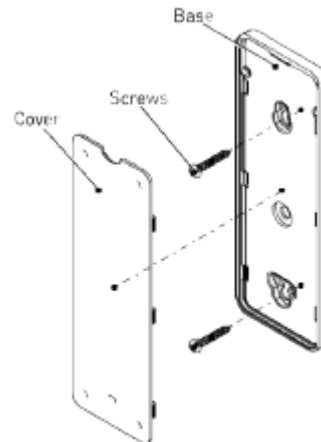

Replace cover by pressing snap latches into place.

Battery

Remove cover from remote press gently in and down to disengage cover.



Install battery with positive (+) side facing up.

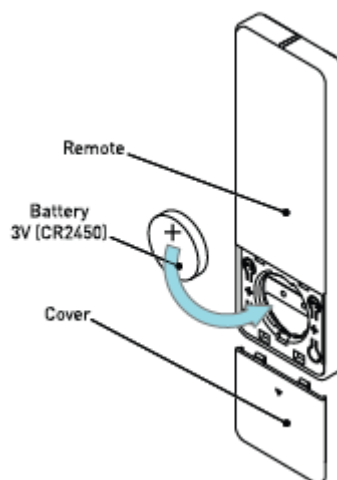

Programming

Pairing Motor to a Remote

Select channel on controller



Hold **P1** button on the motor head for 1 jog

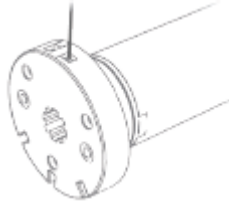

Hold **STOP** on controller



Motor Response



Motor Response



Check Motor Direction

To check travel direction of shade, press **UP** or **DOWN** on controller.



To reverse shade direction, hold both **UP** and **DOWN**.



Motor Response



Setting Limits

Move shade to desired highest or lowest position by pressing the **UP** or **DOWN** buttons



Once you are at your upper limit, hold **UP** and **STOP**.



Once you are at your lower limit, hold **DOWN** and **STOP**.



Holding **DOWN** will make the shade travel. Pressing **DOWN** button moves the shade in small movements. You must press the **STOP** button if the shade is traveling.

Holding **UP** will make the shade travel. Pressing **UP** button moves the shade in small movements. You must press the **STOP** button if the shade is traveling.

DONE!

For Motorization Technical Support call 877-548-0612

Adjusting Upper Limit

You can do this at ANY position. Shade does not need to be at the current upper limit.

Hold **UP** and **STOP** on the controller.



Move shade to desired position



Hold **UP** and **STOP** on the controller.



Adjusting Lower Limit

You can do this at ANY position. Shade does not need to be at the current lower limit.

Hold **DOWN** and **STOP** on the controller.



Move shade to desired position



Hold **DOWN** and **STOP** on the controller.



Copy / Delete channels

Hold P1 button on the motor head for 1 jog.

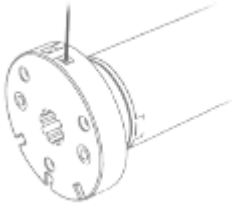

Select channel you wish to add or delete



Hold the **STOP** button on the controller



Delete All Settings

Hold P1 on the motor head for 4 continuous jogs

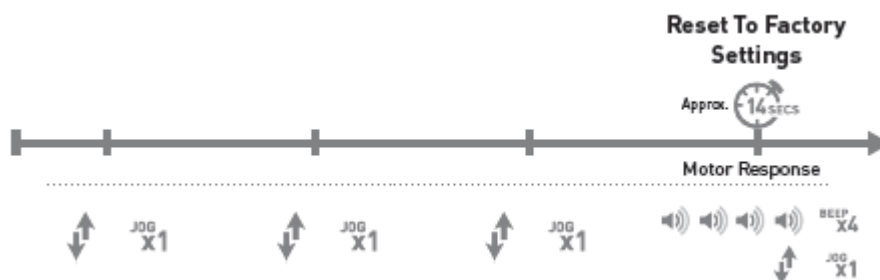
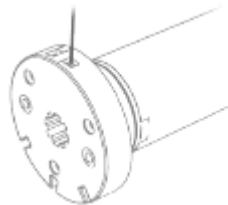

Putting motor to sleep

You will need to put a motor to sleep if you are going to program multiple shades on the same channel or adjust a limit for a specific shade on a group channel. To wake the shade up just press and release the P1 motor head button.

Hold P1 on the motor head
for 2 continuous jogs

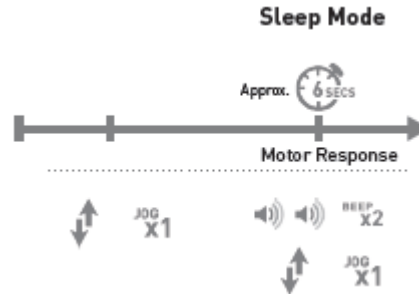
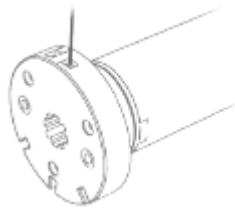

Favorite Position

Move shade to the desired favorite position



Remove battery door on remote.
Press and release P2 on the upper
left corner. The shade will jog once.



Press and release the **STOP**
button on the controller
and the shade will jog



Press and release the **STOP**
button on the controller
and the shade will jog



Tilt Mode

Hold **UP** and **DOWN** on the controller for 1 jog



Hold **UP** and **DOWN** on the controller for 1 jog



In this mode if you just press and release a direction the shade will only move in small increments. This is nice for the Transitional shades. If you want the shade to travel all the way up or all the way down, press and HOLD that direction. To exit this mode and revert back to Roller Mode, do the same steps.

Adjusting Motor Speed

To Increase speed

Press **UP** shade will make 1 jog



Press **UP** shade will make 2 jogs



To decrease speed

Press **DOWN** shade will make 1 jog



Press **DOWN** shade will make 2 jogs



Remove battery door on remote.
Press and release P2 on the upper left corner. The shade will jog once.

